

**NOTE:**  
 ALT R230 THIXO FLASHING APPLIED ON CURB IS SUBJECT TO MECHANICAL DAMAGE FROM VEHICLES & SHOULD BE PROTECTED USING BOLLARDS, STAND-OFFS & STEEL SKID PLATE OR OTHER MEANS AS NECESSARY.

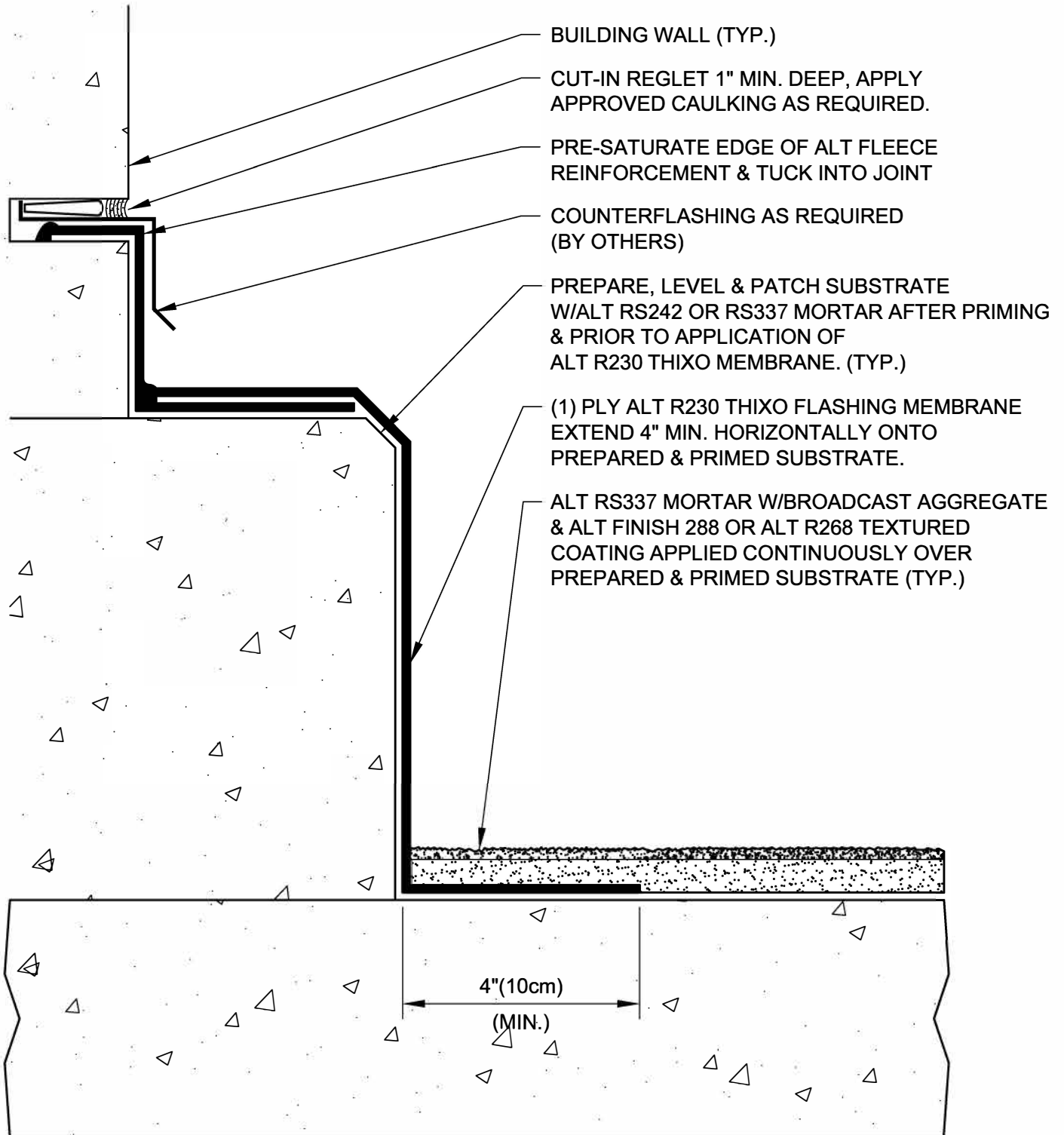

**EXTERIOR CURB FLASHING (TYPICAL)**

DRAWING NO.:

**TN-C3**

REVISION  
0

ISSUE DATE  
10-15-2014

SCALE  
N.T.S.

DRAWN BY  
ALT Global

TN\_C03