

**NOTE:**  
 APPLY DE-BONDING TAPE & MEMBRANE  
 EXPANSION STRIPS AT ALL JOINTS IN  
 METAL-SEE TYPICAL DETAIL. MEMBRANE  
 EXPANSION STRIPS MUST EXTEND THE  
 FULL PROFILE & EXPOSED FACE OF  
 METAL FLASHING.

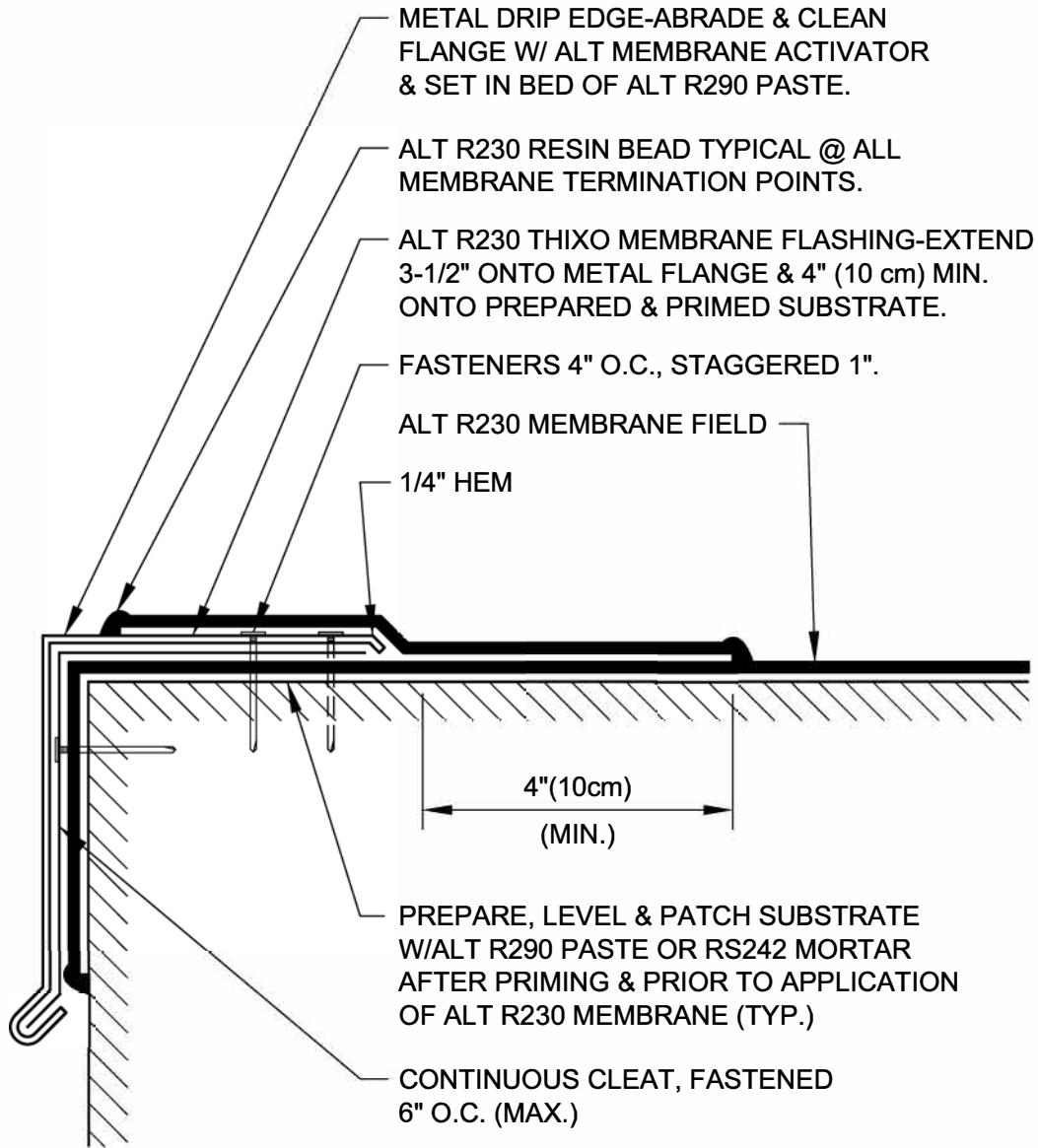

**METAL DRIP EDGE DETAIL**

DRAWING NO.:

**E-1B**

REVISION  
 0

ISSUE DATE  
 10-15-2014

SCALE  
 N.T.S.

DRAWN BY  
 ALT Global

AE\_01B