

ALT FINISH 288 COLOR TOPCOAT  
APPLIED SMOOTH OR MIXED W/ALT  
ANTI-SLIP ADDITIVE (OPTIONAL)

ALT R230 MEMBRANE

4" WIDE MINIMUM REINFORCED  
ALT R230 MEMBRANE STRIP  
APPLIED OVER ALL BOARD  
JOINTS OR VOIDS (TYP.)

ALT PRIMER APPLIED TO  
SUBSTRATE (IF REQ'D.)

ACCEPTABLE RIGID INSULATION  
& COVER BOARD SECURED W/  
ACCEPTABLE ADHESIVE

ACCEPTABLE SUBSTRATE

ACCEPTABLE SBS VAPOR BARRIER  
OR VENTING BASE SHEET  
SECURED TO SUBSTRATE (TYP.)

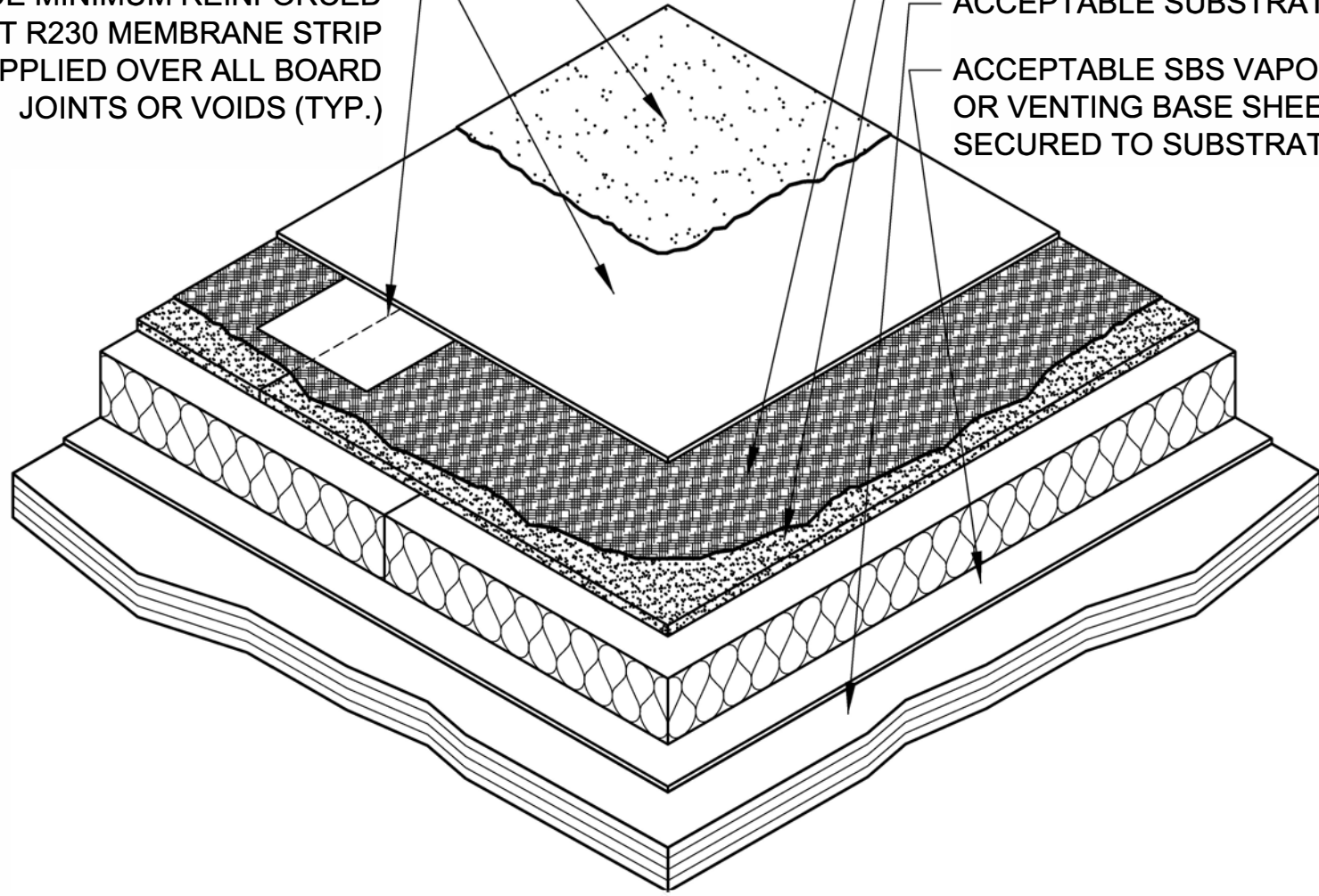

DRAWING NO.:

**R-6C**

AR\_06C

**ALT R230 MEMBRANE ROOF ASSEMBLY w/  
BASE SHEET - OPTION 1 (INSULATED)**

REVISION	0	ISSUE DATE	10-15-2014	SCALE	N.T.S.	DRAWN BY	ALT Global
----------	---	------------	------------	-------	--------	----------	------------



**ALT**