

ALT FINISH 288 SEALCOAT  
APPLIED OVER BROADCAST  
AGGREGATE SURFACING

ALT FINISH 288 WEARING  
COAT & AGGREGATE  
BEDDING LAYER

ALT RS337 MORTAR  
WEARING COAT

ALT R230 REINFORCED  
WATERPROOFING

KILN-DRIED QUARTZ AGGREGATE  
BROADCAST INTO SUPPLEMENTAL  
WET COAT OF ALT FINISH 288

ALT PRIMER APPLIED TO  
PREPARED SUBSTRATE.

APPROVED SUBSTRATE  
PREPARED PER ALT  
REQUIREMENTS.

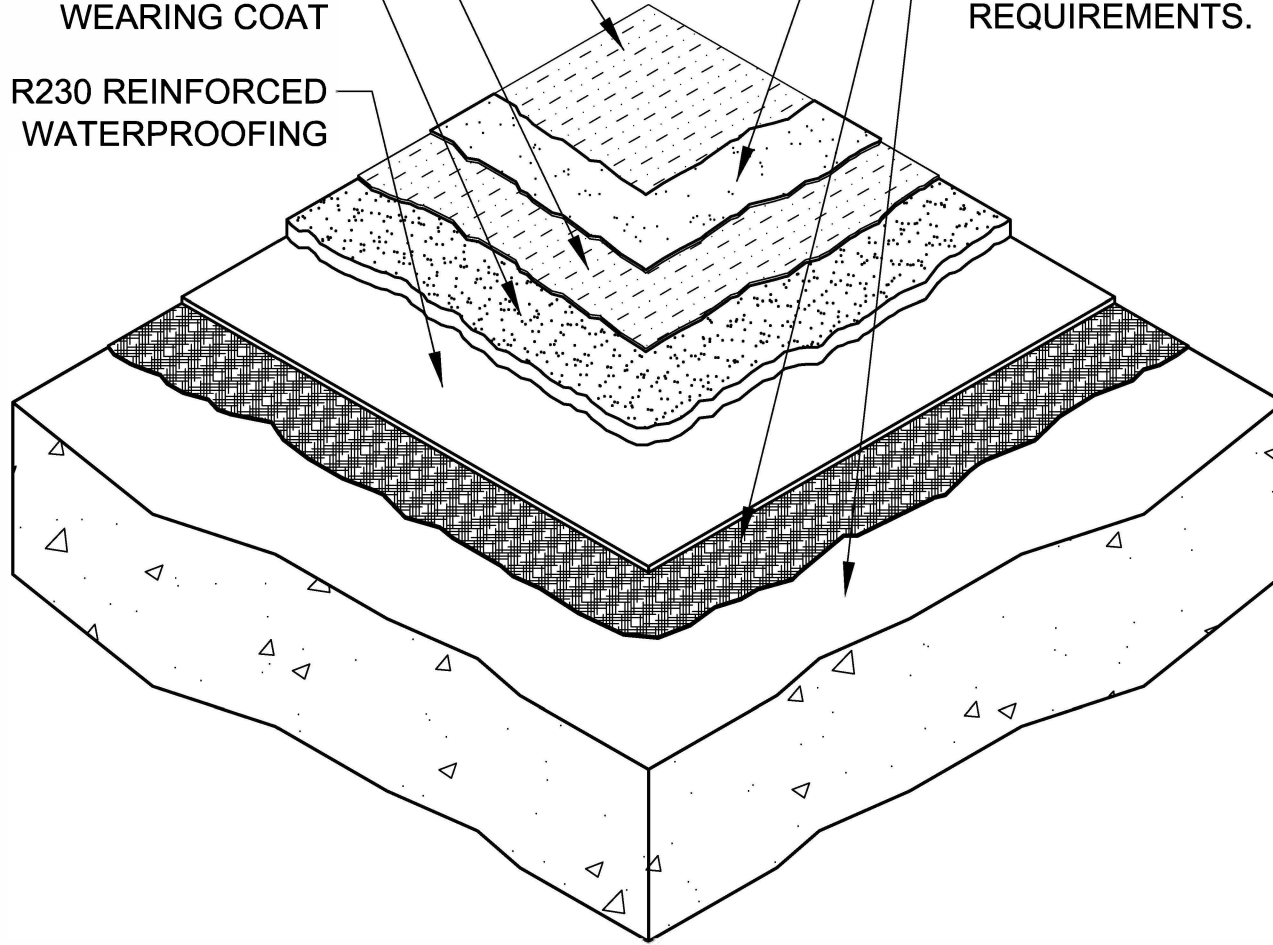

DRAWING NO.:

**TP-2C**

TP\_02C

**ALT R230 REINFORCED W.P. & PEDESTRIAN  
TRAFFIC SYSTEM (SURFACING OPTION 3)**

REVISION	0	ISSUE DATE	10-15-2014	SCALE	N.T.S.	DRAWN BY	ALT Global
----------	---	------------	------------	-------	--------	----------	------------



**ALT**