

STONE OR PRECAST PAVER  
ON DRY SAND SETTING  
BED OVER MEMBRANE

ACCEPTABLE DRAINAGE MAT  
PROTECTION BOARD, OR  
PROTECTION LAYER

ALT R230 MEMBRANE

ALT PRIMER APPLIED TO  
SUBSTRATE (IF REQUIRED)

APPROVED SUBSTRATE  
PREPARED PER ALT  
REQUIREMENTS.

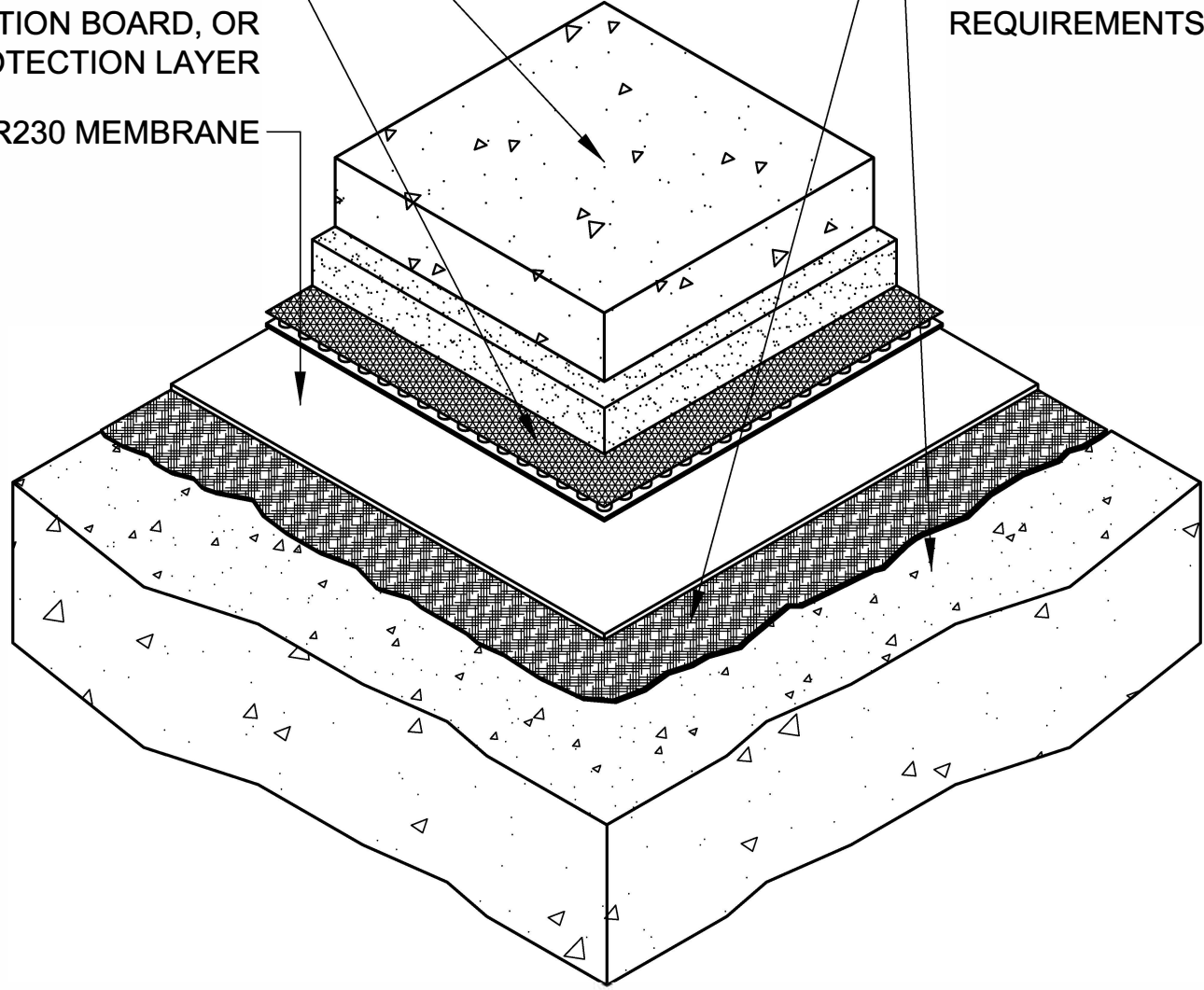

<b>ALT R230 MEMBRANE WATERPROOFING</b>		DRAWN BY <b>ALT Global</b>	
<b>w/DRY-LAID PAVER OVERBURDEN</b>		SCALE N.T.S.	ISSUE DATE 10-15-2014
REVISION 0			