

NOTE:
 SIZE WIDTH OF DE-BONDING TAPE TO PROVIDE UN-ADHERED AREA MINIMUM 5 TIMES LARGER THAN THE MAXIMUM ANTICIPATED EXPANSION. MEMBRANE COVER STRIP MUST EXTEND PAST DE-BONDING TAPE 2" MINIMUM ALL SIDES (TYP.)

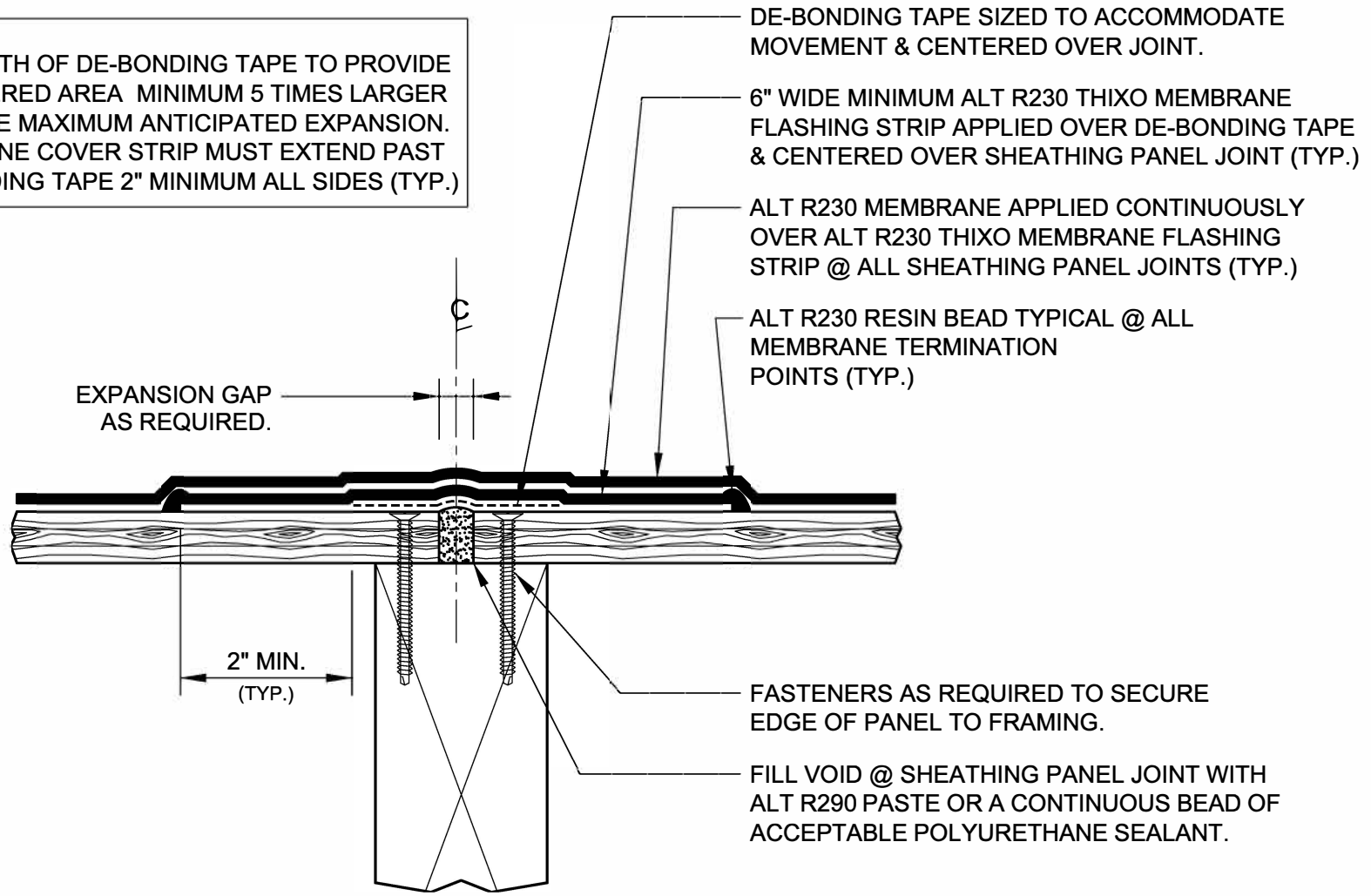

DE-BONDING TAPE SIZED TO ACCOMMODATE MOVEMENT & CENTERED OVER JOINT.

6" WIDE MINIMUM ALT R230 THIXO MEMBRANE FLASHING STRIP APPLIED OVER DE-BONDING TAPE & CENTERED OVER SHEATHING PANEL JOINT (TYP.)

ALT R230 MEMBRANE APPLIED CONTINUOUSLY OVER ALT R230 THIXO MEMBRANE FLASHING STRIP @ ALL SHEATHING PANEL JOINTS (TYP.)

ALT R230 RESIN BEAD TYPICAL @ ALL MEMBRANE TERMINATION POINTS (TYP.)

EXPANSION GAP AS REQUIRED.

2" MIN. (TYP.)

FASTENERS AS REQUIRED TO SECURE EDGE OF PANEL TO FRAMING.

FILL VOID @ SHEATHING PANEL JOINT WITH ALT R290 PASTE OR A CONTINUOUS BEAD OF ACCEPTABLE POLYURETHANE SEALANT.

ROOF SHEATHING PANEL JOINT DETAIL

REVISION	0	ISSUE DATE	10-15-2014	SCALE	N.T.S.	DRAWN BY	ALT Global
----------	---	------------	------------	-------	--------	----------	------------

