

**NOTE:**

APPLY TOPCOAT OF ALT R230 RESIN OVER MEMBRANE & BROADCAST TO REFUSAL WITH KILN-DRIED QUARTZ SILICA @ AREAS WHERE NEW MORTAR WILL CONTACT ALT R230 MEMBRANE.

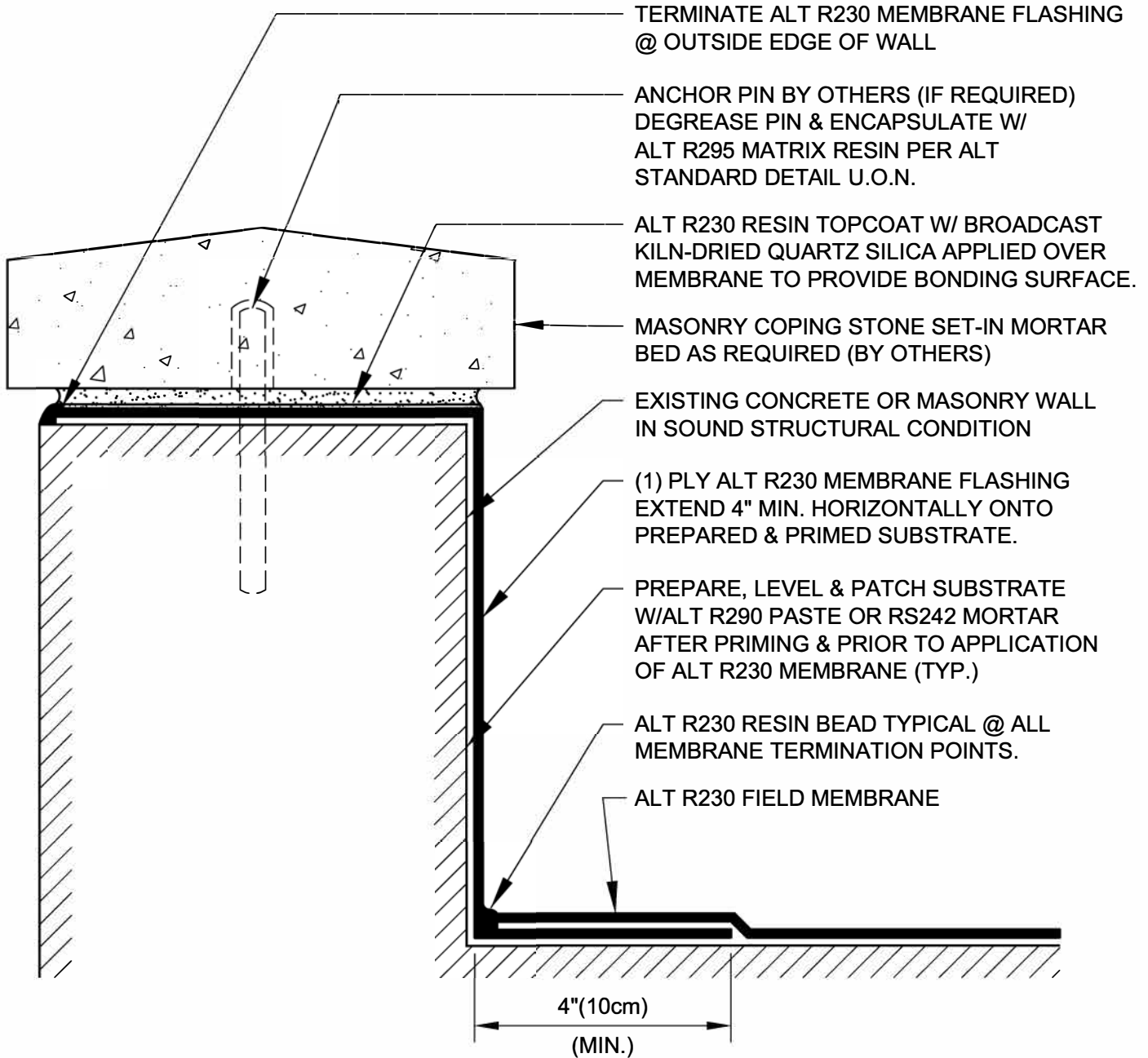

**TYPICAL PARAPET WALL FLASHING  
W/ MORTAR-SET MASONRY COPING**

DRAWING NO.:

**B-2C**

REVISION

0

ISSUE DATE

10-15-2014

SCALE

N.T.S.

DRAWN BY

ALT Global

AB\_02C