

NOTE:

APPLY TOPCOAT OF ALT R230 RESIN OVER MEMBRANE & BROADCAST TO REFUSAL WITH KILN-DRIED QUARTZ SILICA @ AREAS WHERE NEW MORTAR WILL CONTACT ALT R230 MEMBRANE.

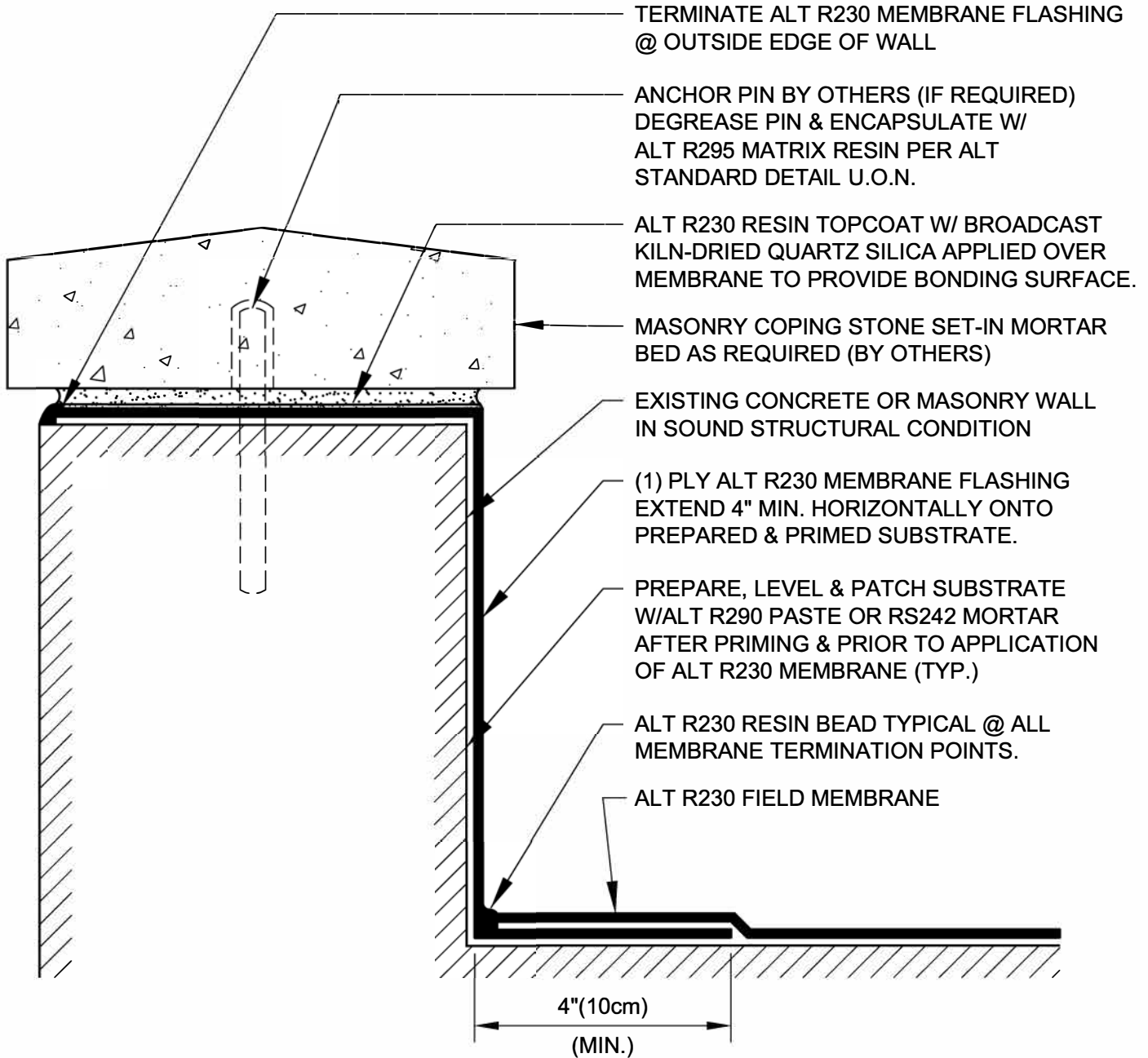

**TYPICAL PARAPET WALL FLASHING
W/ MORTAR-SET MASONRY COPING**

DRAWING NO.:

B-2C

REVISION
0

ISSUE DATE
10-15-2014

SCALE
N.T.S.

DRAWN BY
ALT Global

AB_02C