

NEW POURED CONCRETE WEARING
SLAB (BY OTHERS)

ALT R230 THIXO MEMBRANE FLASHING-EXTEND
6" (15 cm) MINIMUM HORIZONTALLY ONTO
PREPARED & PRIMED SUBSTRATE.

ALT R230 RESIN BEAD TYPICAL @ ALL
MEMBRANE TERMINATION POINTS.

PREPARE, LEVEL & PATCH SUBSTRATE
W/ALT RS242 OR ALT RS337 MORTAR
AFTER PRIMING & PRIOR TO APPL YING
ALT R230 MEMBRANE (TYP.)

ALT R230 RESIN TOPCOAT W/BROADCAST
KILN-DRIED QUARTZ SILICA APPLIED AS
PROTECTION/BONDING COAT FOR CONC.

ALT R230 MEMBRANE (FIELD)

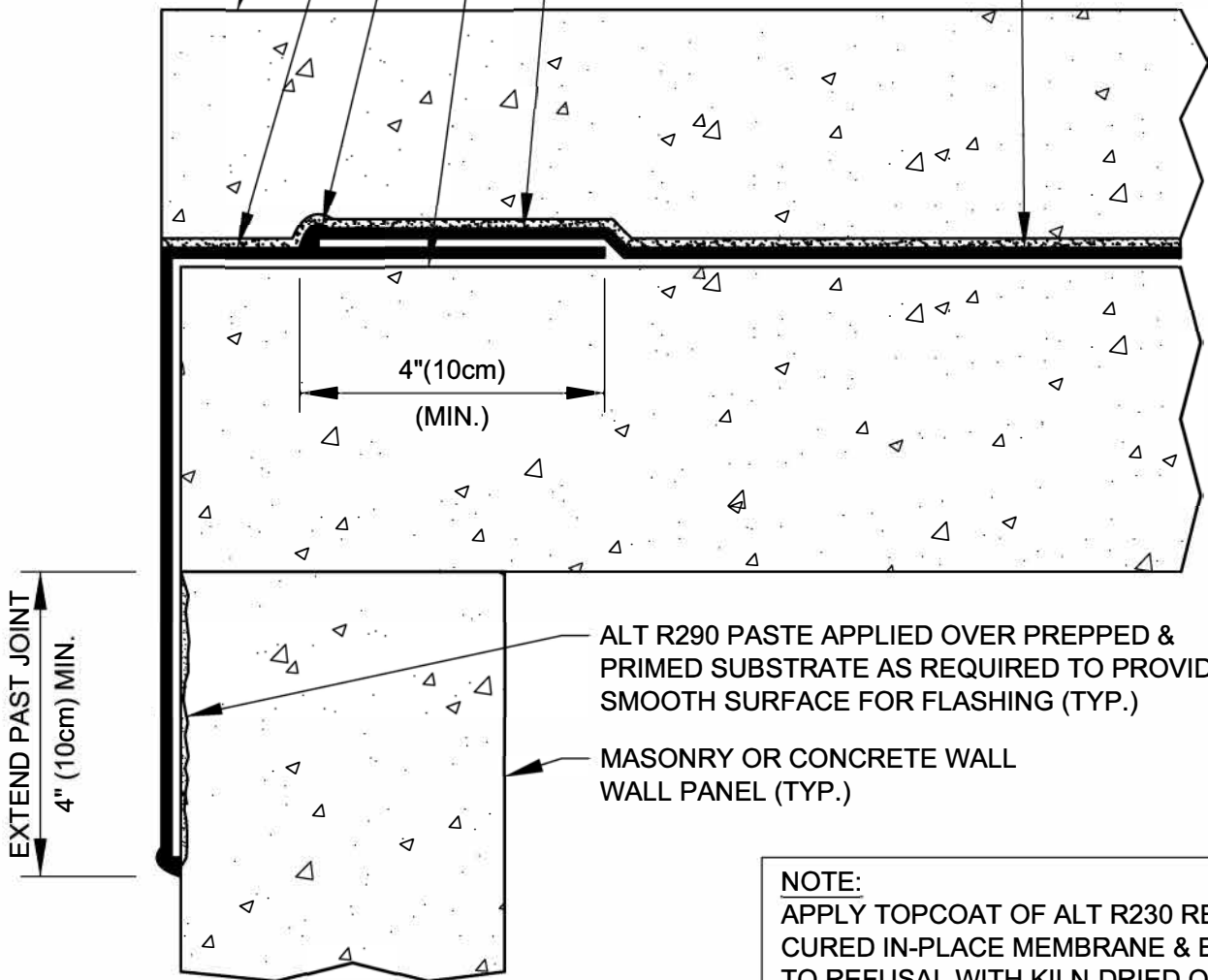

ALT R290 PASTE APPLIED OVER PREPPED &
PRIMED SUBSTRATE AS REQUIRED TO PROVIDE
SMOOTH SURFACE FOR FLASHING (TYP.)

MASONRY OR CONCRETE WALL
WALL PANEL (TYP.)

NOTE:

APPLY TOPCOAT OF ALT R230 RESIN OVER
CURED IN-PLACE MEMBRANE & BROADCAST
TO REFUSAL WITH KILN-DRIED QUARTZ
SILICA @ AREAS WHERE NEW CONCRETE
WILL CONTACT ALT R230 THIXO MEMBRANE.



**TYPICAL SLAB EDGE FLASHING @
CONCRETE/MASONRY SIDEWALK VAULT**

DRAWING NO.:

E-2E

REVISION
0

ISSUE DATE
10-15-2014

SCALE
N.T.S.

DRAWN BY
ALT Global

AE_02E