

NEW POURED CONCRETE WEARING  
SLAB (BY OTHERS)

ALT R230 THIXO MEMBRANE FLASHING-EXTEND  
6" (15 cm) MINIMUM HORIZONTALLY ONTO  
PREPARED & PRIMED SUBSTRATE.

ALT R230 RESIN BEAD TYPICAL @ ALL  
MEMBRANE TERMINATION POINTS.

PREPARE, LEVEL & PATCH SUBSTRATE  
W/ALT RS242 OR ALT RS233 MORTAR  
AFTER PRIMING & PRIOR TO APPLYING  
ALT R230 MEMBRANE (TYP.)

ALT R230 RESIN TOPCOAT W/BROADCAST  
KILN-DRIED QUARTZ SILICA APPLIED AS  
PROTECTION/BONDING COAT FOR CONC.

ALT R230 MEMBRANE (FIELD)

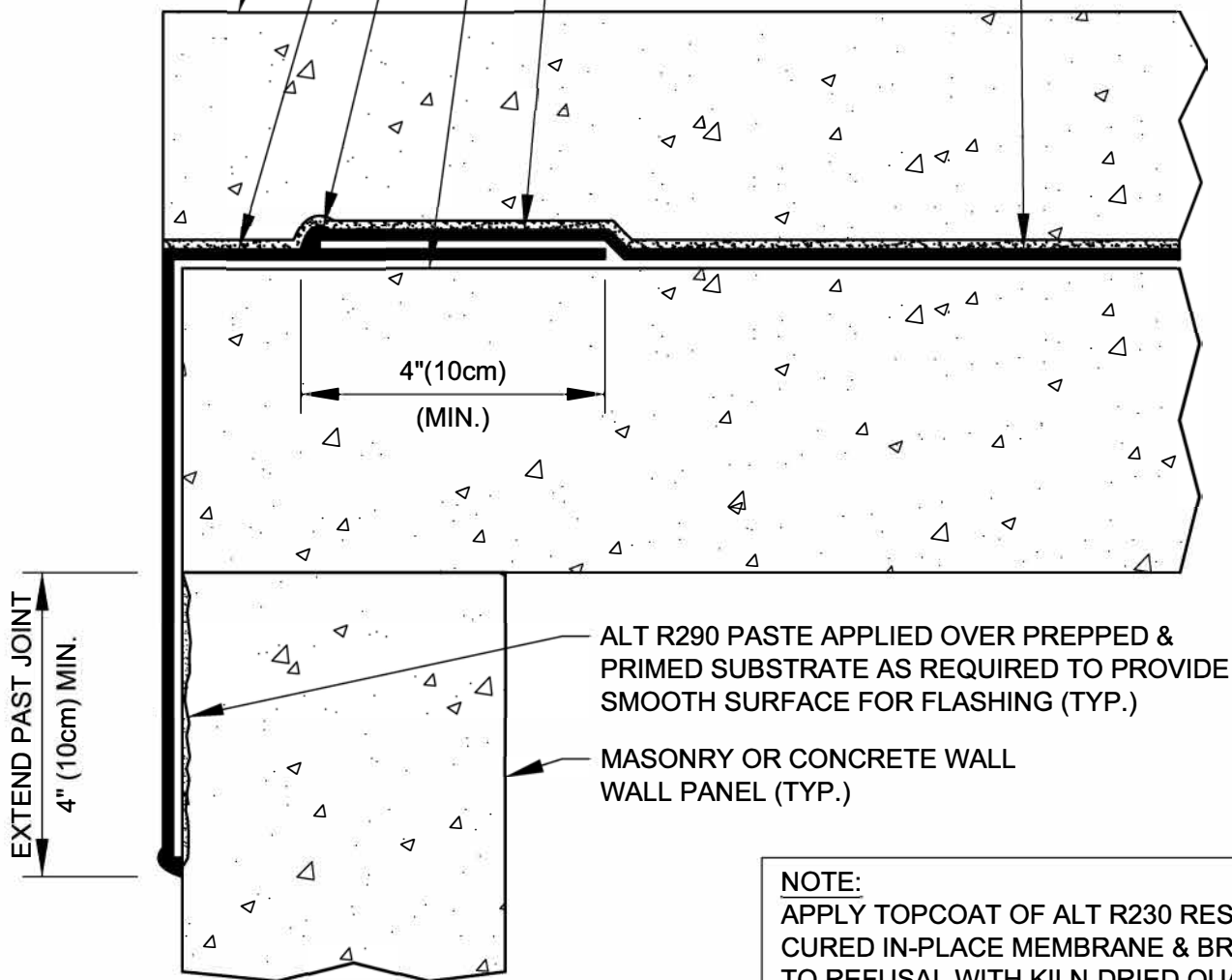

ALT R290 PASTE APPLIED OVER PREPPED &  
PRIMED SUBSTRATE AS REQUIRED TO PROVIDE  
SMOOTH SURFACE FOR FLASHING (TYP.)

MASONRY OR CONCRETE WALL  
WALL PANEL (TYP.)

**NOTE:**

APPLY TOPCOAT OF ALT R230 RESIN OVER  
CURED IN-PLACE MEMBRANE & BROADCAST  
TO REFUSAL WITH KILN-DRIED QUARTZ  
SILICA @ AREAS WHERE NEW CONCRETE  
WILL CONTACT ALT R230 THIXO MEMBRANE.



**TYPICAL SLAB EDGE FLASHING @  
CONCRETE/MASONRY SIDEWALK VAULT**

DRAWING NO.:

**E-2E**

REVISION

0

ISSUE DATE

10-15-2014

SCALE

N.T.S.

DRAWN BY

ALT Global

AE\_02E