

LADDER FRONT VIEW

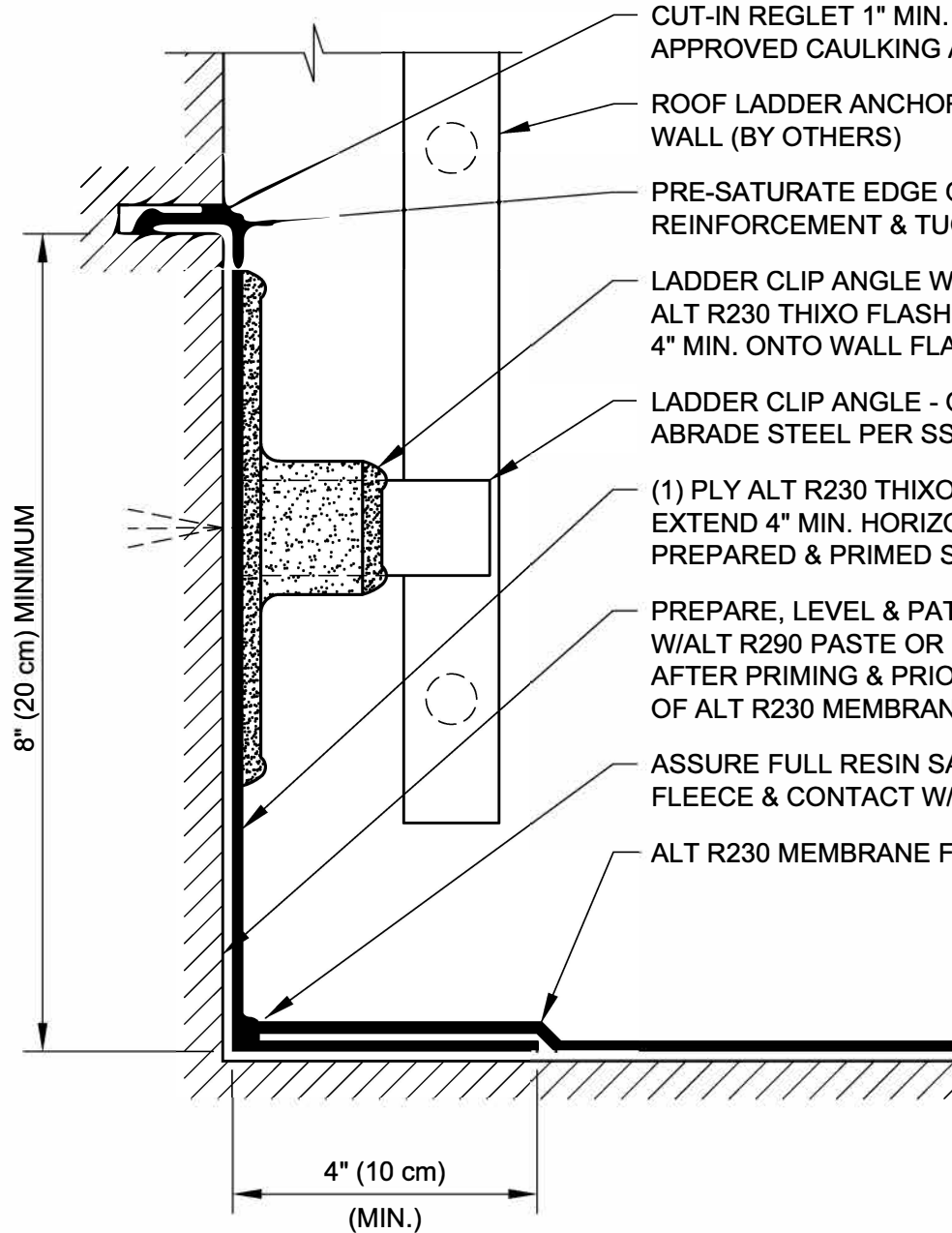

CUT-IN REGLET 1" MIN. DEEP, APPLY APPROVED CAULKING AS REQUIRED.

ROOF LADDER ANCHORED TO BUILDING WALL (BY OTHERS)

PRE-SATURATE EDGE OF ALT FLEECE REINFORCEMENT & TUCK INTO JOINT

LADDER CLIP ANGLE WRAPPED W/ ALT R230 THIXO FLASHING EXTENDED 4" MIN. ONTO WALL FLASHING.

LADDER CLIP ANGLE - CLEAN & ABRASE STEEL PER SSPC-SP3.

(1) PLY ALT R230 THIXO FLASHING EXTEND 4" MIN. HORIZONTALLY ONTO PREPARED & PRIMED SUBSTRATE.

PREPARE, LEVEL & PATCH SUBSTRATE W/ALT R290 PASTE OR RS242 MORTAR AFTER PRIMING & PRIOR TO APPLICATION OF ALT R230 MEMBRANE (TYP.)

ASSURE FULL RESIN SATURATION OF FLEECE & CONTACT W/SUBSTRATE.

ALT R230 MEMBRANE FIELD

DRAWING NO.:

M-2F

AM_02F

WALL MOUNTED LADDER BASE FLASHING

REVISION	0	ISSUE DATE	10-15-2014	SCALE	N.T.S.	DRAWN BY	ALT Global
----------	---	------------	------------	-------	--------	----------	------------

