

ALT FINISH 288 SEALCOAT
APPLIED OVER BROADCAST
AGGREGATE SURFACING

ALT RS233 MORTAR
WEARING COAT

ALT R230 REINFORCED
WATERPROOFING

KILN-DRIED QUARTZ AGGREGATE
BROADCAST INTO SUPPLEMENTAL
WET COAT OF ALT RS233 MORTAR

ALT PRIMER APPLIED TO
PREPARED SUBSTRATE.

APPROVED SUBSTRATE
PREPARED PER ALT
REQUIREMENTS.

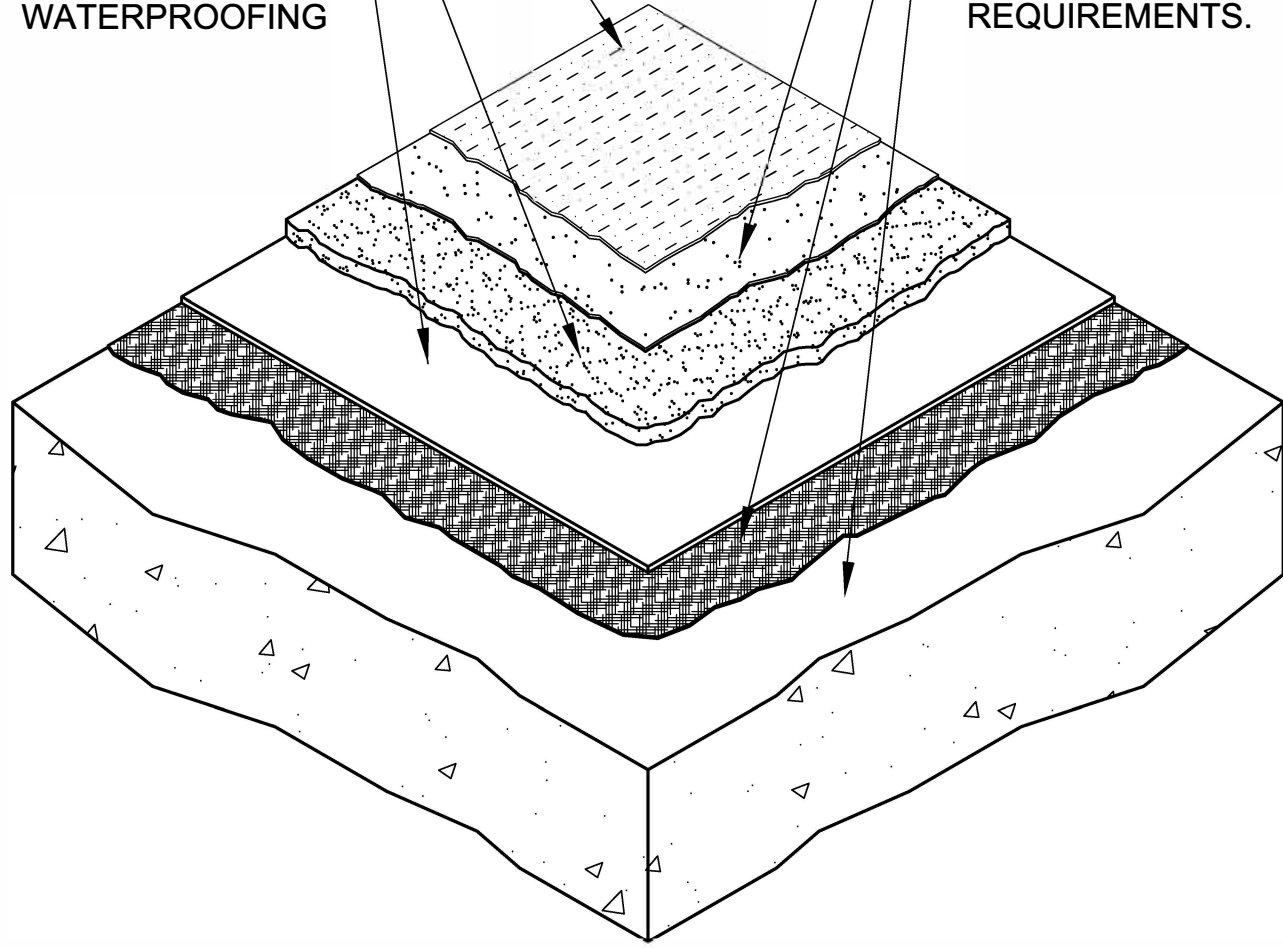

DRAWING NO.:
TV-2A
TV 02A

**ALT REINFORCED VEHICULAR TRAFFIC SYSTEM
(MAIN DECK, PARKING STALLS & AISLES)**

REVISION	0	ISSUE DATE	10-15-2014	SCALE	N.T.S.	DRAWN BY	ALT GLOBAL
----------	---	------------	------------	-------	--------	----------	------------

