

ALT FINISH 288 COLOR TOPCOAT
APPLIED SMOOTH OR MIXED W/ALT
ANTI-SLIP ADDITIVE (OPTIONAL)

ALT R230 MEMBRANE

4" WIDE MINIMUM REINFORCED
ALT R230 MEMBRANE STRIP
APPLIED OVER ALL BOARD
JOINTS OR VOIDS (TYP.)

ALT PRIMER APPLIED TO
SUBSTRATE (IF REQ'D.)

ACCEPTABLE RIGID INSULATION
& COVER BOARD SECURED W/
ACCEPTABLE ADHESIVE

ACCEPTABLE SUBSTRATE

ACCEPTABLE SBS VAPOR BARRIER
OR VENTING BASE SHEET
SECURED TO SUBSTRATE (TYP.)

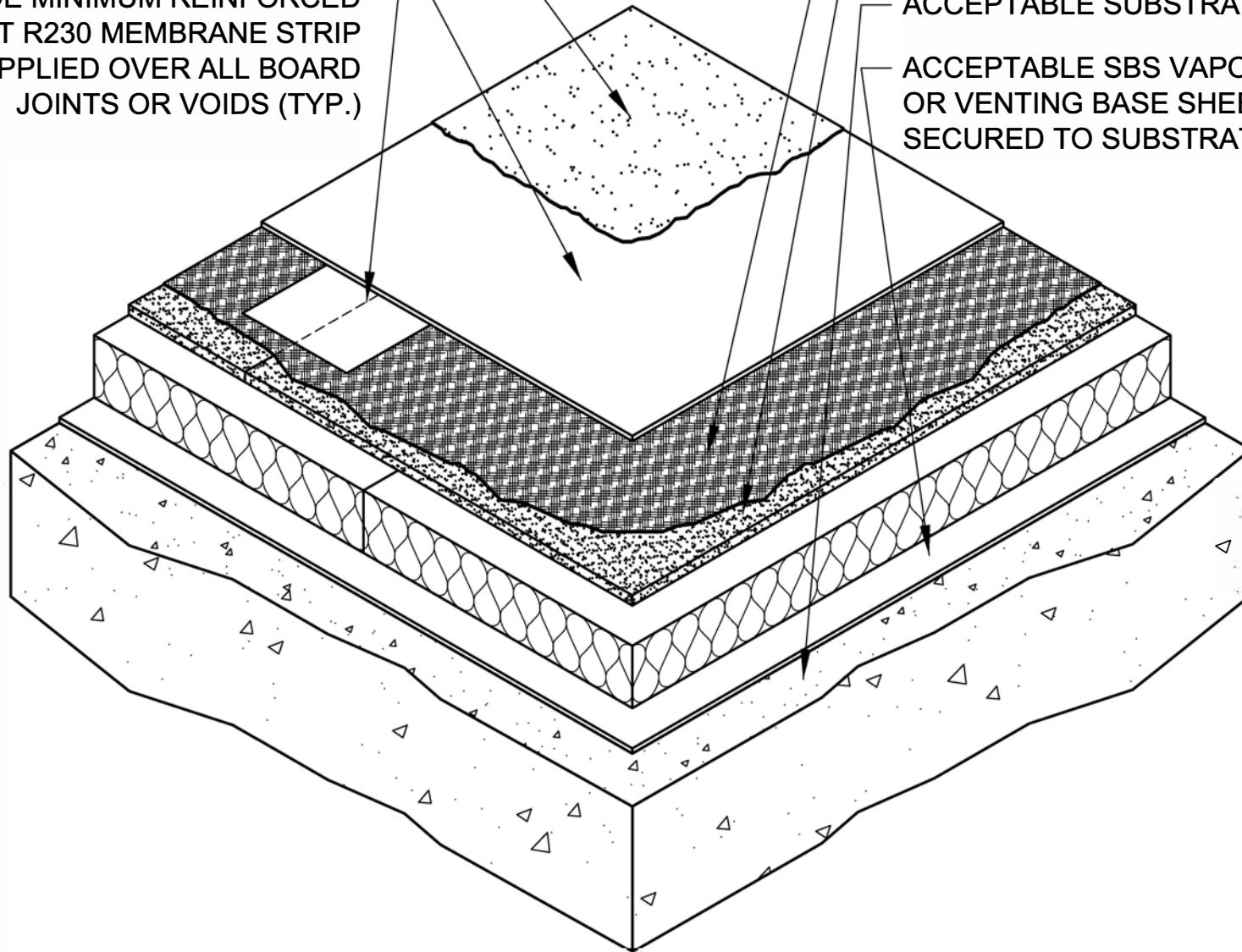

DRAWING NO.:

R-6A

AR_06A

**ALT R230 MEMBRANE ROOF ASSEMBLY W/
VAPOR BARRIER - OPTION 1 (INSULATED)**

REVISION	0	ISSUE DATE	10-15-2014	SCALE	N.T.S.	DRAWN BY	ALT Global
----------	---	------------	------------	-------	--------	----------	------------

