

DRAWING NO.:

R-7B

AR_07B

**ALT R230 MEMBRANE ROOF ASSEMBLY
BUR RECOVERY - OPTION 2 (NON-INSULATED)**

REVISION	ISSUE DATE	SCALE	DRAWN BY
0	10-15-2014	N.T.S.	ALT Global



ALT RS291 TEXTURED FINISH
SLIP-RESISTANT COLOR
TOPCOAT (OPTIONAL)

ALT R230 MEMBRANE

ALT RS233 MORTAR LEVELING
COAT APPLIED OVER ALT PRIMER
FOR LEVELING & FILLING MINOR
ALLIGATORING WHEN REQ'D.

ALT PRIMER APPLIED TO
PREPARED BUR (TYP.)

EXISTING SMOOTH OR GRAVEL
SURFACED (GRAVEL REMOVED)
BUR PREPARED AS SUBSTRATE
FOR NEW MEMBRANE (TYP.)

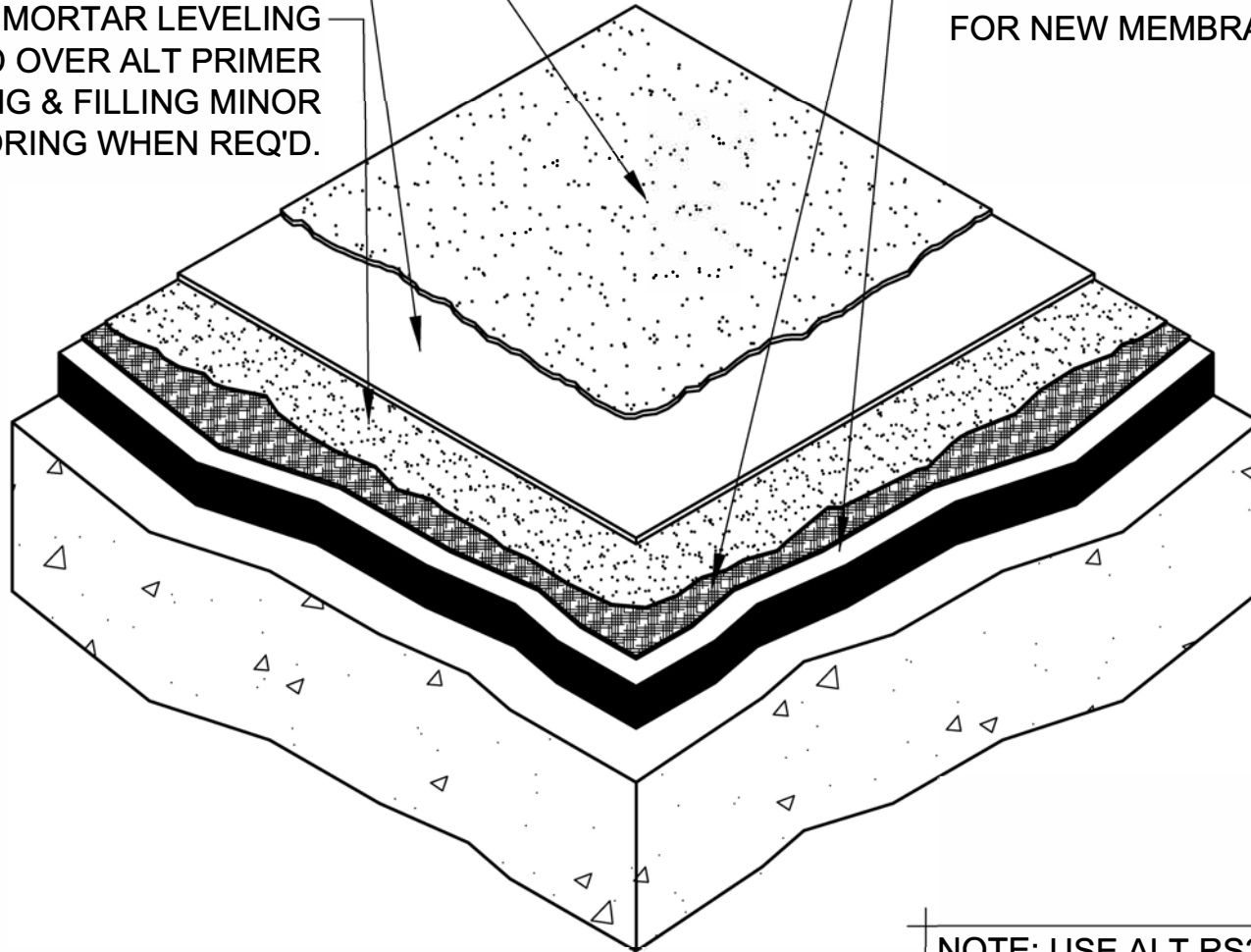

NOTE: USE ALT RS233 MORTAR
AS NEEDED TO FILL ALLIGATORING,
MINOR FISSURES & LEVEL ROOF
BIRD-BATHS OR DEPRESSIONS.