

NOTE:
 ALT R230 THIXO FLASHING APPLIED ON CURB IS SUBJECT TO MECHANICAL DAMAGE FROM VEHICLES & SHOULD BE PROTECTED USING BOLLARDS, STAND-OFFS & STEEL SKID PLATE OR OTHER MEANS AS NECESSARY.

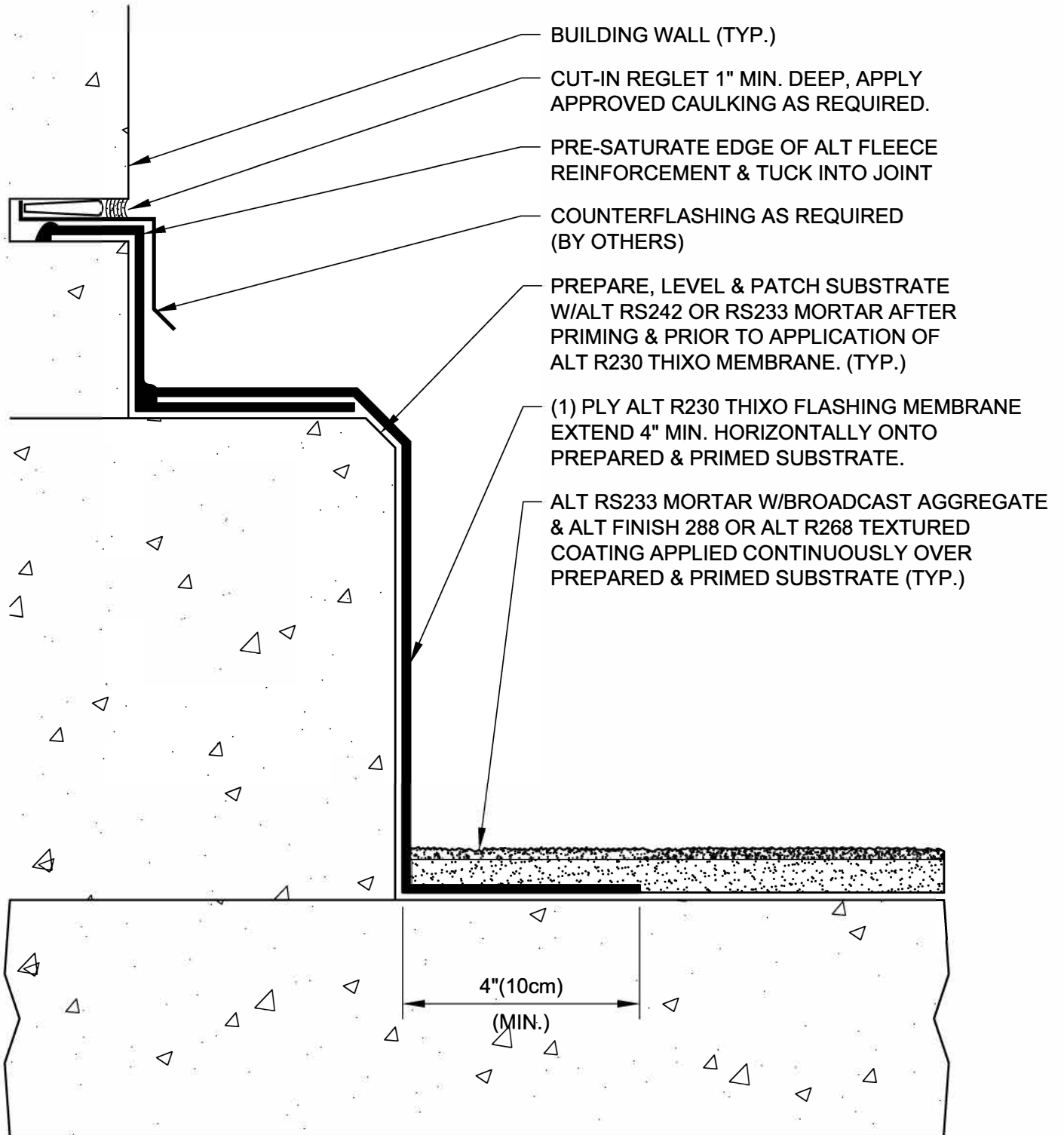

EXTERIOR CURB FLASHING (TYPICAL)

DRAWING NO.:

TN-C3

REVISION
0

ISSUE DATE
10-15-2014

SCALE
N.T.S.

DRAWN BY
ALT Global

TN_C03