

ALT FINISH 288 SEALCOAT
APPLIED OVER BROADCAST
AGGREGATE SURFACING

ALT FINISH 288 WEARING
COAT & AGGREGATE
BEDDING LAYER

ALT RS233 MORTAR
WEARING COAT

ALT R230 REINFORCED
WATERPROOFING

KILN-DRIED QUARTZ AGGREGATE
BROADCAST INTO SUPPLEMENTAL
WET COAT OF ALT FINISH 288

ALT PRIMER APPLIED TO
PREPARED SUBSTRATE.

APPROVED SUBSTRATE
PREPARED PER ALT
REQUIREMENTS.

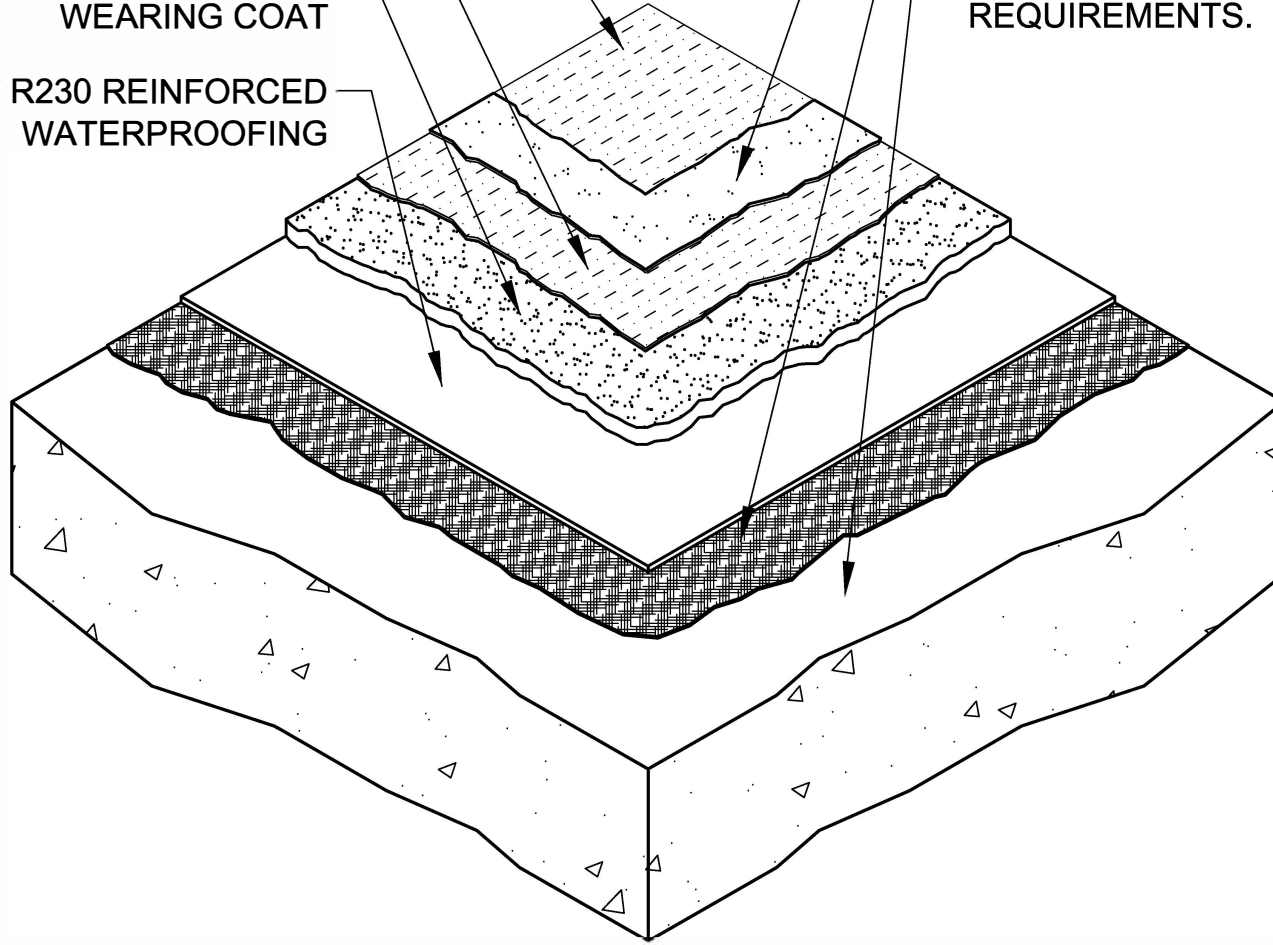

DRAWING NO.:

TP-2C

TP_02C

**ALT R230 REINFORCED W.P. & PEDESTRIAN
TRAFFIC SYSTEM (SURFACING OPTION 3)**

REVISION	0	ISSUE DATE	10-15-2014	SCALE	N.T.S.	DRAWN BY	ALT Global
----------	---	------------	------------	-------	--------	----------	------------



ALT