

ALT R230 THIXO RESIN BEAD TYPICAL@ ALL MEMBRANE TERMINATION POINTS

ALT RS233 MORTAR W/ALT R268 TEXTURED COATING TRAFFIC SURFACING

ALT R230 THIXO MEMBRANE APPLIED CONTINUOUSLY OVER DECK SUBSTRATE (TYP.)

(1) PLY ALT R230 THIXO MEMBRANE FLASHING EXTENDED HORIZONTALLY 6" MINIMUM ON SLAB & TIE-ON DRAIN BODY 1" MINIMUM AS SHOWN

PREPARE, LEVEL & PATCH SUBSTRATE AS REQUIRED W/ALT RS242 OR RS233 MORTAR AFTER PRIMING & PRIOR TO APPLYING ALT R230 THIXO MEMBRANE (TYP.)

6" MIN. OVERLAP

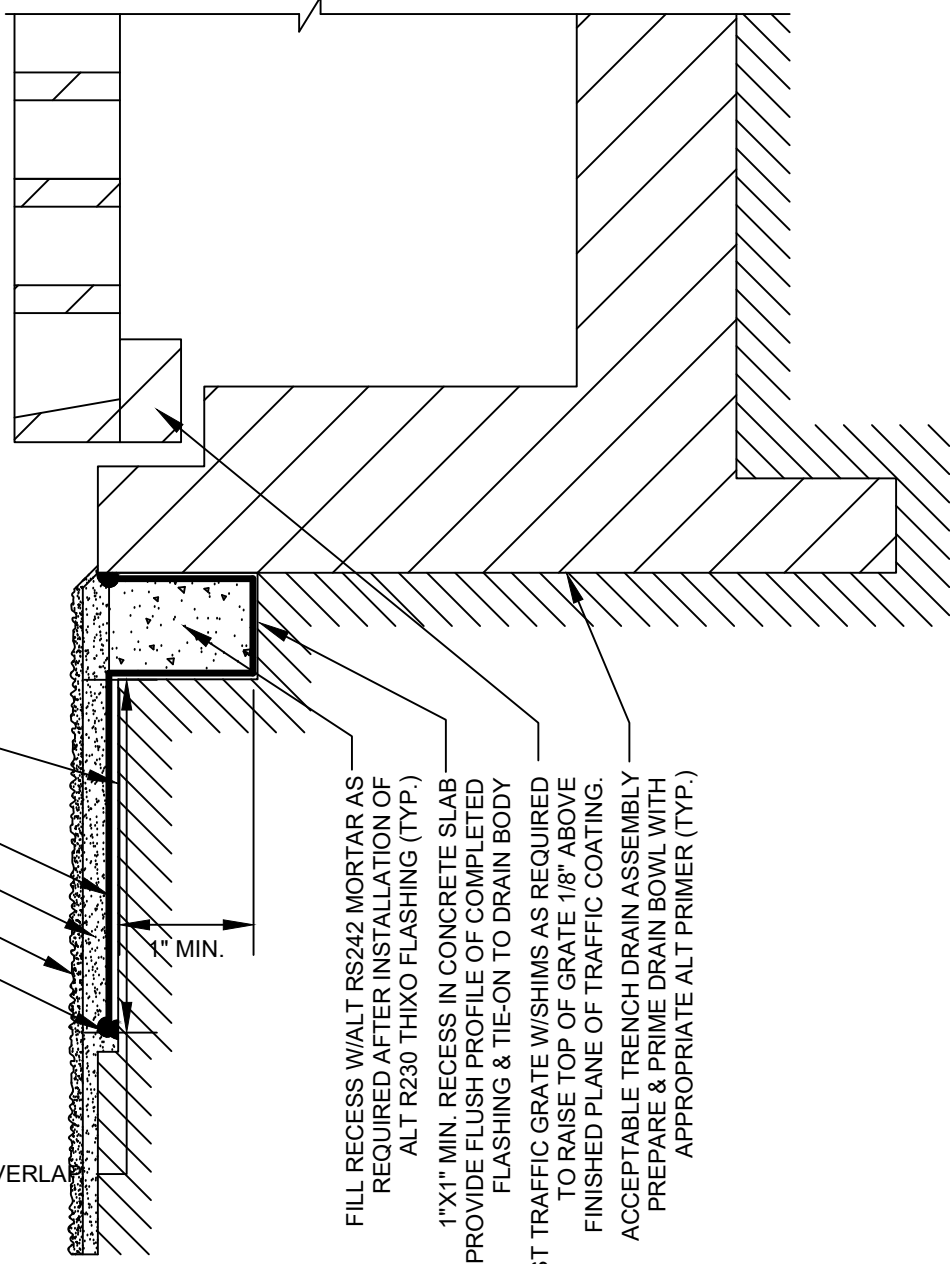

FILL RECESS W/ALT RS242 MORTAR AS REQUIRED AFTER INSTALLATION OF ALT R230 THIXO FLASHING (TYP.)

1"X1" MIN. RECESS IN CONCRETE SLAB TO PROVIDE FLUSH PROFILE OF COMPLETED FLASHING & TIE-ON TO DRAIN BODY

ADJUST TRAFFIC GRATE WISHIMS AS REQUIRED TO RAISE TOP OF GRATE 1/8" ABOVE FINISHED PLANE OF TRAFFIC COATING. ACCEPTABLE TRENCH DRAIN ASSEMBLY PREPARE & PRIME DRAIN BOWL WITH APPROPRIATE ALT PRIMER (TYP.)



TRENCH DRAIN FLASHING

DRAWING NO.:

TN-D2

REVISION

0

ISSUE DATE

03/23/17

SCALE

N.T.S.

DRAWN BY

M.S.

TN-D2