

- ALT R230 THIXO RESIN BEAD TYPICAL@ ALL MEMBRANE TERMINATION POINTS
- ALTRS233 MORTAR W/BROADCAST AGGREGATE & ALT FINISH 288 OR ALT r268 TEXTURED COATING APPLIED OVER ALT MEMBRANE
- (1) PLY ALT R230 THIXO MEMBRANE FLASHING EXTENDED HORIZONTALLY 6" MINIMUM BEYOND DRAIN BODY & TURN DOWN 4 " MINIMUM.
- PREPARE, LEVEL & PATCH SUBSTRATE AS REQUIRED W/ALT RS242 OR RS233 MORTAR AFTER PRIMING & PRIOR TO APPLYING ALT R230 THIXO MEMBRANE (TYP.)

6" MIN. OVERLAP

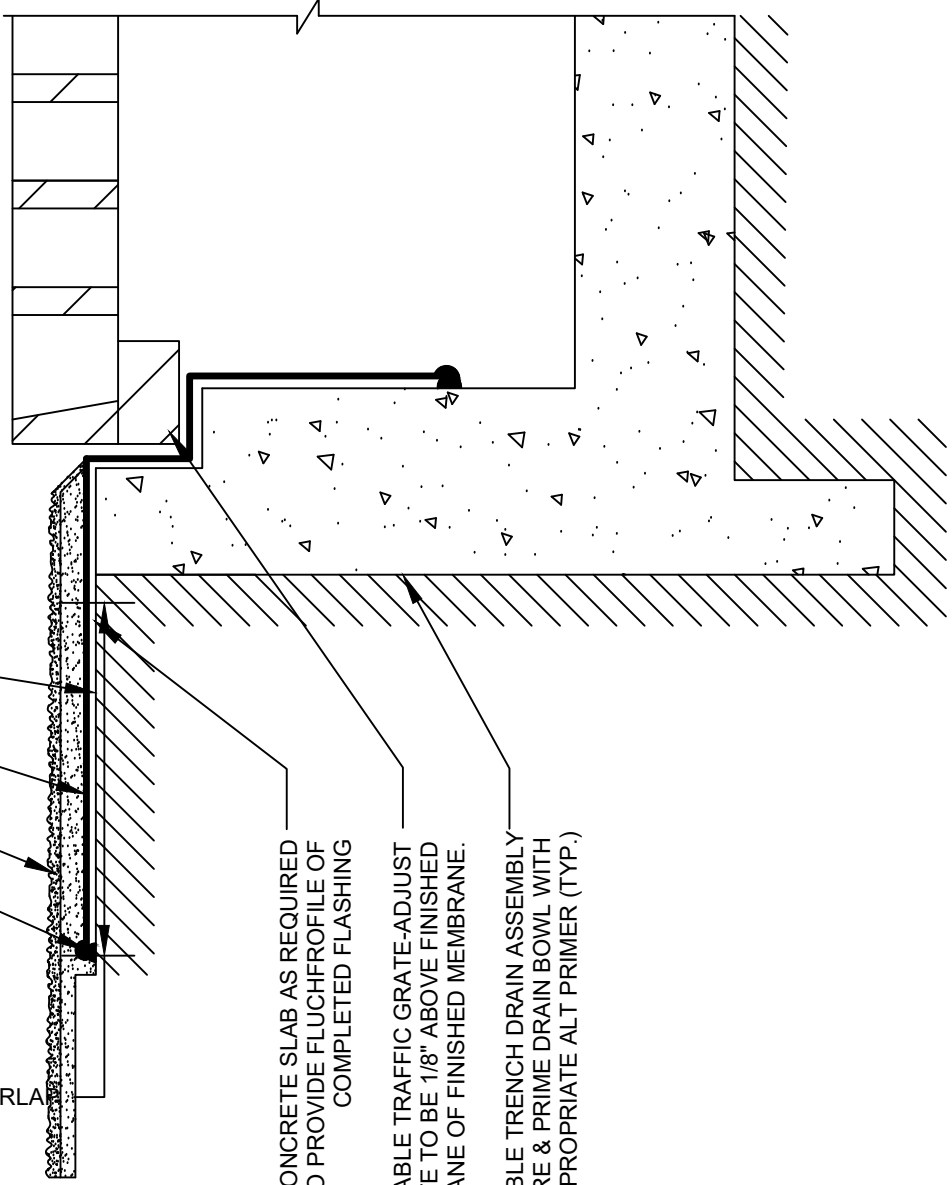

- RECESS CONCRETE SLAB AS REQUIRED TO PROVIDE FLUCHPROFILE OF COMPLETED FLASHING
- ACCEPTABLE TRAFFIC GRATE-ADJUST TOP GRATE TO BE 1/8" ABOVE FINISHED PLANE OF FINISHED MEMBRANE.
- ACCEPTABLE TRENCH DRAIN ASSEMBLY PREPARE & PRIME DRAIN BOWL WITH APPROPRIATE ALT PRIMER (TYP.)



TRENCH DRAIN FLASHING

DRAWING NO.: TN-D3  
TN-D2

REVISION	ISSUE DATE	SCALE	DRAWN BY
0	04/03/17	N.T.S.	M.S.